

## Slide gates SPB

The slide gates SPB are used for closing of hoppers with loose and non-adhesive materials. They are applied in places, accessible to manual control.

### Description

The slide gate is made of steel S235.

The frame is made of rolled profiles. The plate is made of 6 mm thick sheet and is sealed with graphite packing and is guided in the slide gate frame by means of steel bars. The slide gate is painted with synthetic outer coat, the plate and the inside slide gate surface with ground coat. The slide gate control proceeds with a hand wheel. The plate feed is provided with a trapezoidal thread screw.

### Operating conditions

The slide gate in the standard design is used for closing of hopper and containers with loose materials up to temperatures of 150 °C. The slide gate may be mounted only with the flange in horizontal position.

When agreed with the manufacturer, the basic connecting dimensions, or the plate and the sealing bar material can be modified. By using special sealing materials and paints it is possible to use the slide gate for higher temperatures.

### Designation

The slide gate is designated:

**SPB size**

Example of designation with size of flange 400x400 mm:

**SPB 400**

Other specifications:

Finish undercoat

Finish undercoat + topcoat with RAL color

Technical data

Dimensions and weights

A x B	C	D	L1	L2	n1xd1	n2xd2	n3xm1	v1	Weight [ kg ]
200 x 200	300	250	472	150	6xØ15	2xM12	1x160	50	29,91
250 x 250	350	250	547	175	6xØ15	2xM12	1x160	75	36,16
315 x 315	415	250	644,5	207,5	6xØ19	2xM16	1x200	92,5	44,96
400 x 400	500	250	772	250	6xØ19	2xM16	1x200	135	54,80
500 x 500	600	250	922	300	9xØ19	3xM16	2x200	85	72,29

Basic dimensions

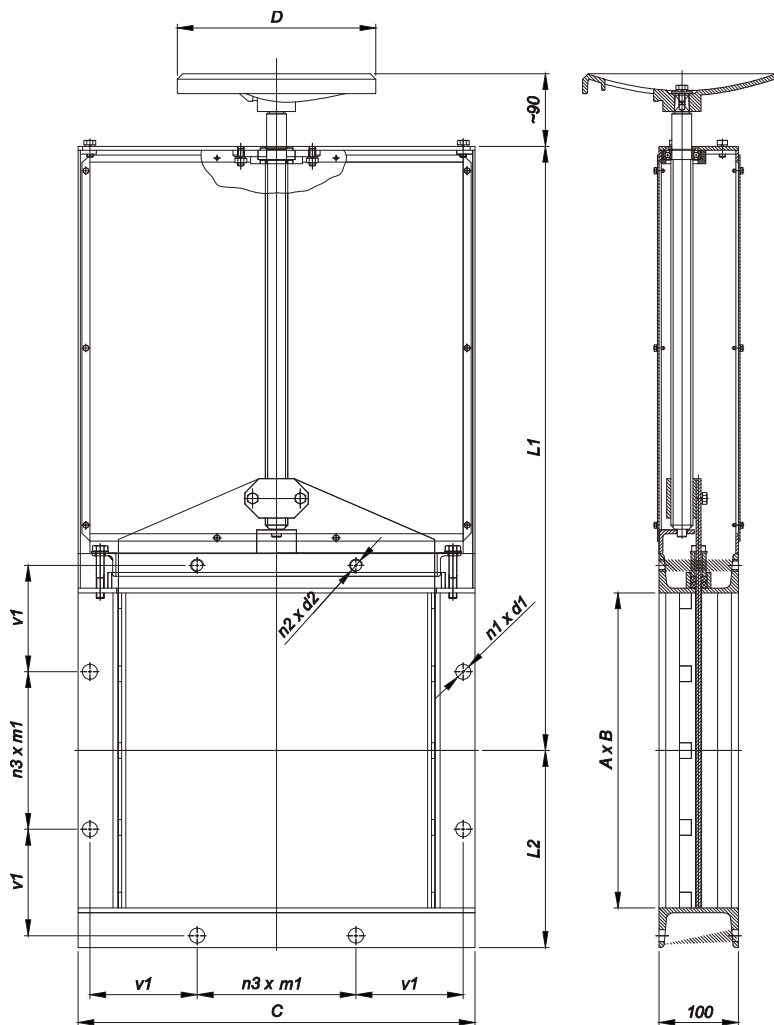

Valid from: 5.2.2014

Elaborated: Pavelka Petr

EKOMETAL - E, spol. s r.o.  
Draby 710  
566 01 Vysoké Myto  
Czech Republic

Tel.: +420 465 423 392  
+420 465 423 860  
Fax: +420 465 423 385  
E-mail: info@ekometal.cz

VAT-No.: CZ60932228  
Registration: Regional court Hradec Kralove, section C, insert 5879  
Bank: CSOB a.s. - Branch office Vysoké Myto  
IBAN: CZ40 0300 0000 0002 5295 4222  
SWIFT: CEKOCZPP